

**J.A. CHEWS SUB-DIVISION**  
 Of Lot #1; of the 16 acre lots in Bryans Addition #2 on the N.W., original survey S.F. Austin #9 Lots 1 to 14 inclusive. J.A. Chews Re-subdivision of blocks #11; 12; 13; & 14 of J.A. Chews subdivision of lot #4 of the 16 acre lots in Bryans Addition #2 on the N.W. original survey S.F. Austin #9. Lots #1 to 19 inclusive.  
 D.R. 28 Pg. 205 2-27-'04  
 Scale: 1" = 100'  
 (See PRIDDY-LAWRENCE RE-SURVEY) 4-1-13

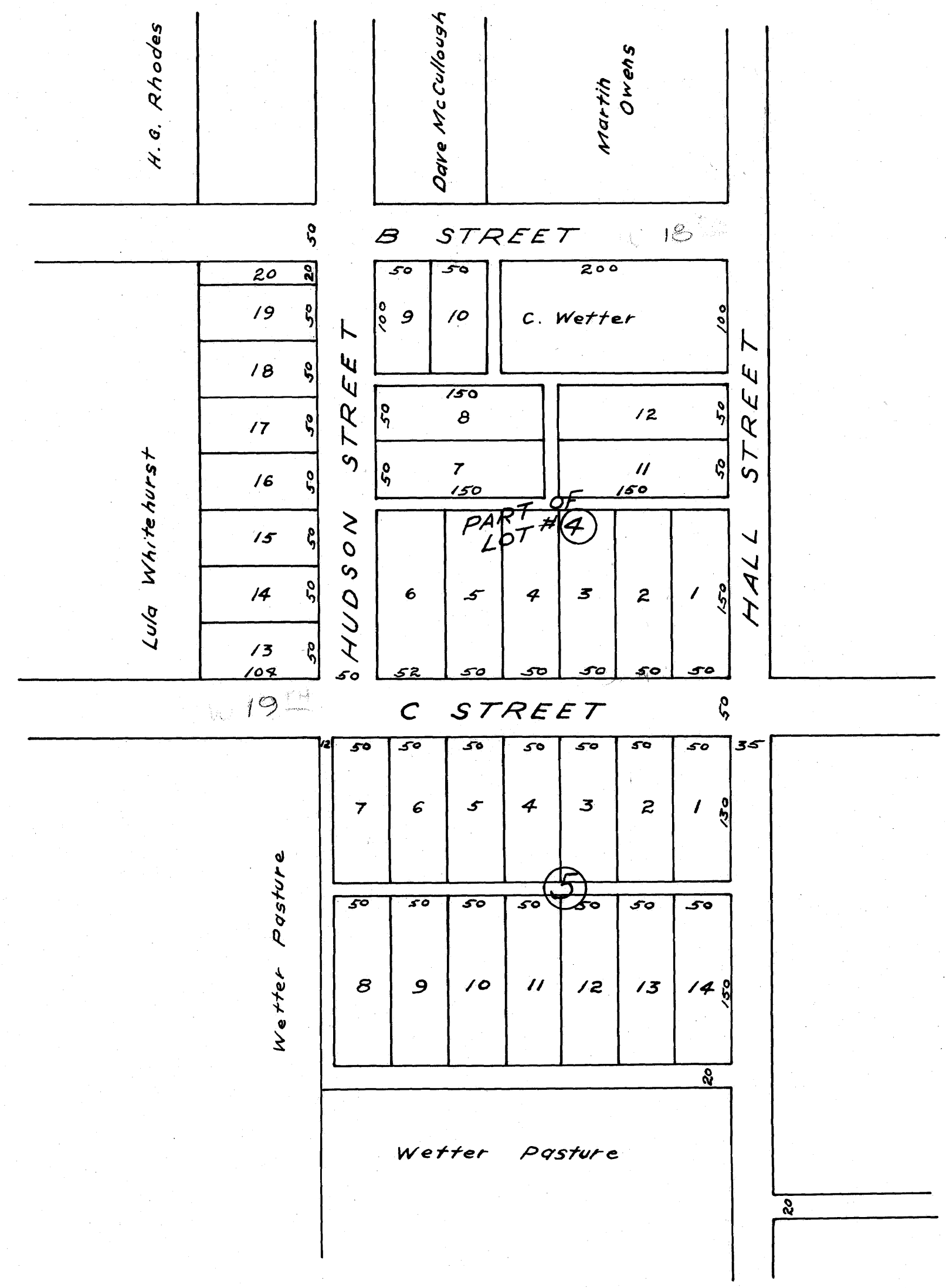
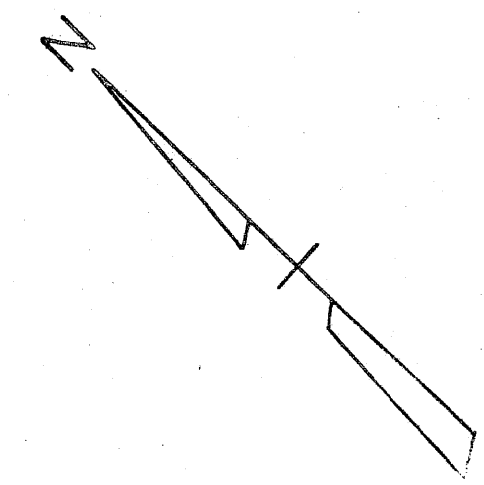

on page 10  
 11/10/03